

BRB02

BRB05

Restraining a bowed cavity or solid wall using BowTies into joist side

METHOD STATEMENT

1. Mark the positions for the BowTie clearance holes on the external wall. (Refer to the Specification Notes for typical spacing requirements.)
2. Drill the clearance hole (typically 12mm \varnothing) through the masonry to line up with the middle third of the timber joist, away from the edges, and continue through the first joist.
3. Clean out the hole to clear any dust or debris.
4. Insert the BowTie power support tool into an SDS rotary hammer drill and place the BowTie into the support tool.
5. Drive the BowTie into and through the second joist.
6. Place the end of the nozzle of the resin applicator over the exposed end of the BowTie. Masking tape may be placed around the hole to protect the surface of the wall from resin spillage. Cloth may also be wrapped around the nozzle to help seal the opening during installation and protect the wall face from resin spillage.
7. Pump the resin applicator to inject HeliFix resin into the hole. The resin will track down the tie, following its helical profile. Inject resin until the hole in the wall is filled completely (near skin only if installed into a cavity wall).
8. Allow the resin to gel (normally 15 to 20 minutes).
9. Make good all holes at the surface using either a mixture of sand, cement and oxide colouring to match the original surrounding brick surfaces or a silicone sealant coated with brick dust or drillings.

CAUTION. Always locate, identify and isolate any electrical, water or gas services which may be present in the wall or the wall cavities and can pose a safety risk before drilling or cutting. Always take the necessary safety precautions. Use electrical safety gloves and wear appropriate footwear and eyewear.

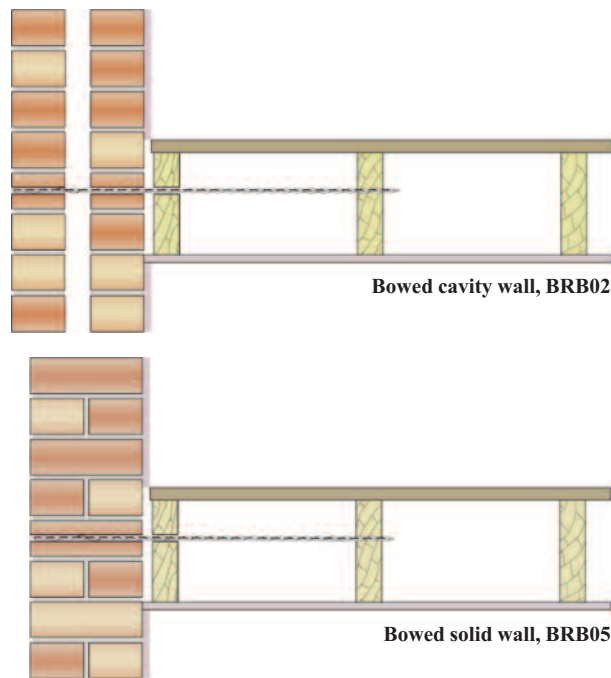

RECOMMENDED TOOLING

For drilling and insertion of BowTiesSDS rotary hammer drill 650/700w
 For installation of BowTiesBowTie support tool
 For injection of HeliFix resin.....Applicator gun with nozzle

Specification Notes

The following criteria are to be used unless specified otherwise:

- A. BowTie penetration into the side grain of the timber joist must be 45mm to 70mm or the tie should be driven through the joist.
- B. The maximum horizontal spacing between BowTies is 600mm.
- C. Ensure that all joists into which BowTies are to be installed are both sound and secure.
- D. Install HeliFix remedial wall ties if existing ties are defective in any way. Refer to Repair Details BRT01–03 for details on HeliFix remedial tie installation.

The above specification notes are for general guidance only and HeliFix reserves the right to amend details/notes as necessary.

GENERAL NOTES

- If your application differs from this repair detail or you require specific technical information, call HeliFix on 1300 66 70 71.